

ACCESSORIES FOR CAM LOCKS

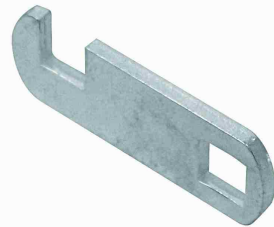

ITEM No.	Cams Types	Pcs. per pack No.
090	A/O - straight	12
092	A/10 - bended	12
093	A/15 - bended	12

Full galvanized steel cams, straight and bended.

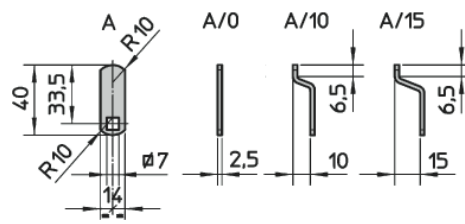

ITEM No.	Cams Types	Pcs. per pack No.
094	B/O - straight	12
096	B/10 - bended	12
097	B/15 - bended	12

Hook-shaped galvanised steel cams, straight and bended.

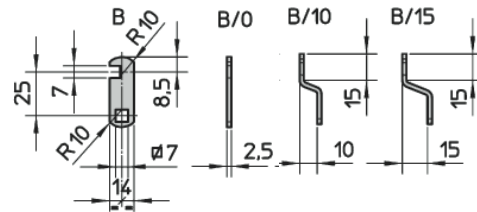

ITEM No.	Pcs. per pack No.	FOR BRASS SERIES
2.0.1002.064.00.000	-	4-prong steel washer, 20 mm hole
2.0.1001.065.00.000	-	Brass nut for 20 mm body.

58030310205015 - 06/2011

Viro quality "Cam" locks are the most versatile and can be used for all applications. Especially suitable for master key systems. The numerous cams available can satisfy all requirements.

NON-CENTERED PLUG CAM LOCKS - MADE IN ITALY

- **Body:** solid brass fully threaded, milled on one side to prevent rotation.
- **Plug:** non-centered.
- **Brass pins and counterpins;** phosphor bronze pin springs.
- **Versions:**
 - ✓ single version, key removable in vertical position (reference pin for key removal) and 180° turn (1020-1050-1060 series);
 - ✓ Right and left hand version, key removable in vertical position and 90°turn (1000 series).
- **Universal application** on any type of wooden or metal furniture, for drawers and hinged or sliding doors; complete with a cam (to be chosen between the numerous available ones), can satisfy each requirement.
- **Keys:** supplied with 2 brass nickel plated Viro profile keys.
 - Versions available with patented profile keys (form trademark) which can only be duplicated by Viro (.PB profile) or versions which can be duplicated only by Viro Authorized Centers (.PV profile).
- Supplied with A/0 cam, four-prong washer and securing nut (1000-1050-1060 series).
- Single packs in 12 pieces boxes.
- Nickel plated version also available (add ".9" to the item code).
- **All special executions are possible.**
- Keying kit available.

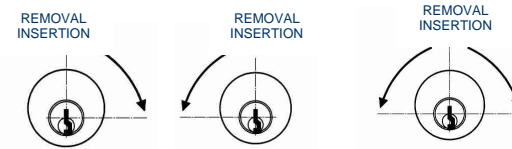

1000 SERIES 1050-1060 SERIES

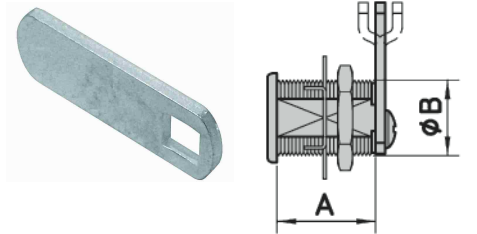

ITEM No.	Length mm A	Diameter mm B	Keys Item No.	Unit weight g	Pcs. per pack No.
1002.90	17,5	20	011	85	12
1003.90	21	20	013	95	12
1005.90	31	20	013	115	12

The item code should be followed by the code for the required version (.1= right or .2= left). E.g. 1002.90.1.9= Cam lock 1002, right, nickel-plated, with A/0 cam.

1000 SERIES:
Right and left hand version
Key removable in vertical position
90°turn
Standard A/0 cam.

ITEM No.	Length mm A	Diameter mm B	Keys Item No.	Unit weight g	Pcs. per pack No.
1052.90	17,5	20	011	84	12
■ # 1053.90	21	20	013	94	12
■ # 1054.90	26	20	013	105	12
■ # 1055.90	31	20	013	115	12
■ # 1056.90	35	20	013	125	12

- For versions with patented profile keys the item code should be followed by: .PB or .PV
- # Items that can be ordered with .PV or .PB patented profiles on request.

1050 SERIES:
Single version,
Key removable in vertical position
180°turn
Reference pin for key removal
Standard A/0 cam.

ITEM No.	Length mm A	Diameter mm B	Keys Item No.	Unit weight g	Pcs. per pack No.
1062.90	17,5	15	019	58	12

1060 SERIES:
Single version
Key removable in vertical position
180°turn
Standard A/0 cam.

NON-CENTERED PLUG CAM LOCKS – 1020 SERIES – MADE IN ITALY

- **Body:** solid brass fully threaded, milled on two opposite side to prevent rotation.
- **Keys:** supplied with 2 Viro profile nickel-plated brass keys.
- **Supplied** with securing nut, screw and washer for cam securing.
- **Application:** on any type of wooden or metal furniture (1020 series needs a 4-prong washer and a cam to be chosen between the available ones), for drawers and hinged or sliding doors.
- Single packs, in plastic bag, with 12 pieces boxes.
- Nickel plated version in polyethylene bags in 50 pieces boxes also available (add ".9" to the item code).
- **All special executions are possible.**

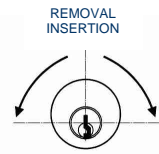
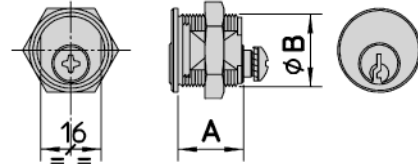

1020 SERIES

N.B. cam not supplied.

ITEM No.	Length mm A	Diameter mm B	Keys Item No.	Unit weight g	Pcs. per pack No.
1020	17,3	19	011	58	12

1020 SERIES:
Single version
Key removable in vertical position
180° turn.

CENTERED PLUG CAM LOCKS - MADE IN ITALY

- **Body:** solid brass, fully threaded, milled on one side to prevent rotation.
- **Centered plug.**
- **Brass pins and counterpins;** phosphor bronze pin springs.
- **Single version** with key removable in 2 position and 90° turn.
- **Universal application** on any type of wooden or metal furniture, for drawers and hinged or sliding doors; complete with a cam (to be chosen between the numerous available ones), can satisfy each requirement.
- **Keys:** supplied with 2 brass nickel plated keys.
- **Supplied complete with A/0 cam, 4-prong washer and securing nut.**
- Single packs with 12 pieces boxes.
- Nickel plated version also available (add ".9" to the item code).
- **All special executions are possible (except for MK systems).**
- Keying kit available.

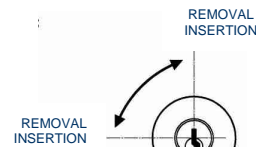
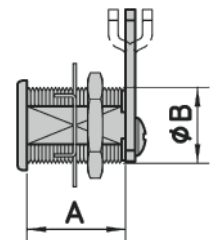
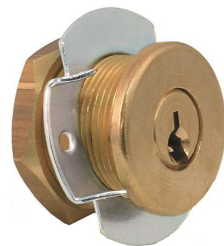

1010 SERIES

ITEM No.	Length mm A	Diameter mm B	Keys Item No.	Unit weight g	Pcs. per pack No.
1012.90	17,5	20	011	83	12
1013.90	21	20	013	93	12

1010 SERIES:
Single version
Key removable in two positions
90° turn
Standard A/0 cam.

NON-CENTERED PLUG CAM LOCKS – FAI BY VIRO

- **Body:** solid brass, fully threaded, milled on one side to prevent rotation.
- **Non-centered plug.**
- **Brass pins and counterpins;** phosphor bronze pin springs.
- **Single version** with key removable in vertical position (reference pin for key removal) and 180° turn.
- **Universal application** on any type of wooden or metal furniture, for drawers and hinged or sliding doors; complete with a cam (to be chosen between the numerous available ones), can satisfy each requirement.
- **Keys:** supplied with 2 brass nickel plated Viro profile keys.
- **Supplied complete with A/0 cam and screw galvanised steel, 4-prong washer and securing nut.**
- Single packs with 12 pieces boxes.
- Nickel plated version also available (add ".9" to the item code).
- Standard KA execution available for item 1252.90 only.
- MK master key systems are not available.

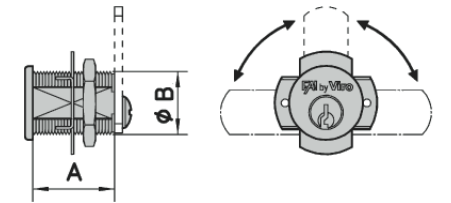
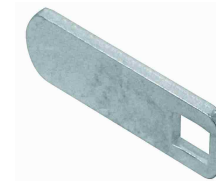

ITEM No.	Length mm A	Diameter mm B	Keys Item No.	Unit weight g	Pcs. per pack No.
1252.90	17,5	20	011	75	12
1253.90	21	20	013	85	12
1254.90	26	20	013	95	12

Single version
Key removable in vertical position
180° turn
Reference pin for key removal
Standard A/0 cam.

CAM LOCKS – FAI BY VIRO ZAMAK VERSION

- 5 wafers (item 1031) or 6 wafers (item 1032 and 1033).
- **Body:** chrome plated zamak body, fully threaded.
- **Supplied** with cam and nut.
- **Body** and keys are numbered.
- **Keys:** supplied with 2 keys.
- Single packs, in plastic bag, with 50 pieces boxes.
- **KD:** max 200 or 300 pieces.
- Special executions or special finishes are not available.

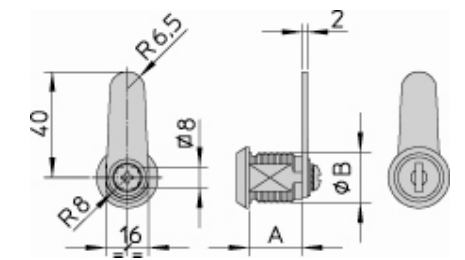

ITEM No.	Length mm A	Diameter mm B	Keys Item No.	Unit weight g	Pcs. per pack No.
1031	16	19	1.046.A	55	50
1032	20	19	1.046.B	60	50
1033	25	19	1.046.B	65	50

1030 SERIES:
Single version
Key removable in two positions
90° turn
Standard cam.